

WALK-IN DOOR ASSEMBLY INSTALLATION INSTRUCTIONS



IMPORTANT
AFTER INSTALLATION, STORE THIS MANUAL IN
THE MANUAL POCKET PROVIDED ON THE INSIDE
OF THE OUTER DOOR PANEL

290829



Contents

Walk-in Door Assembly Instructions 3

Raised Walk-In Door Illustration (Installed) 4

Walk-In Door Illustration (Installed) 5

Walk-in Door Opening and Closing Instructions..... 6

Field Installation Of Auger Hood 7

Walk-In Door Parts Identification 8

Walk-In Door - Complete Assembly Parts List 9

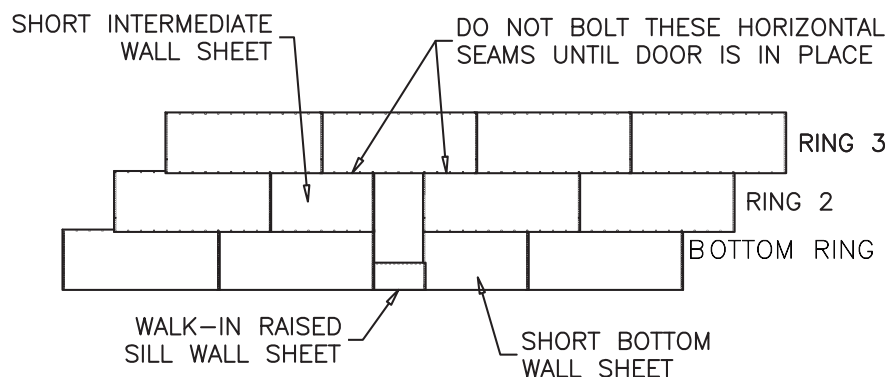

WALK-IN RAISED DOOR
(STANDARD POSITION)

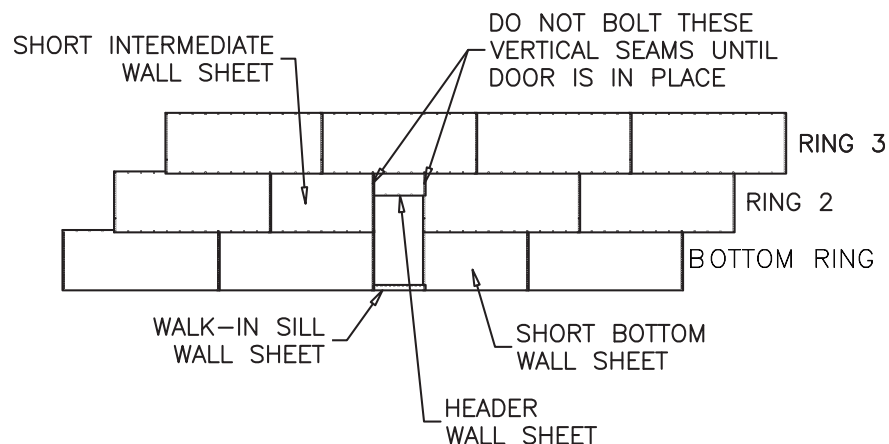

WALK-IN DOOR
(OPTIONAL POSITION)

STEP 1

ASSEMBLE BOTTOM WALL SHEET RINGS LEAVING THE WALK IN DOOR OPENING AS SHOWN

FOR WALL SHEET DETAILS REFER TO FARM BIN BOOKLET (290025).

DO NOT BOLT AROUND WALK IN DOOR OPENING

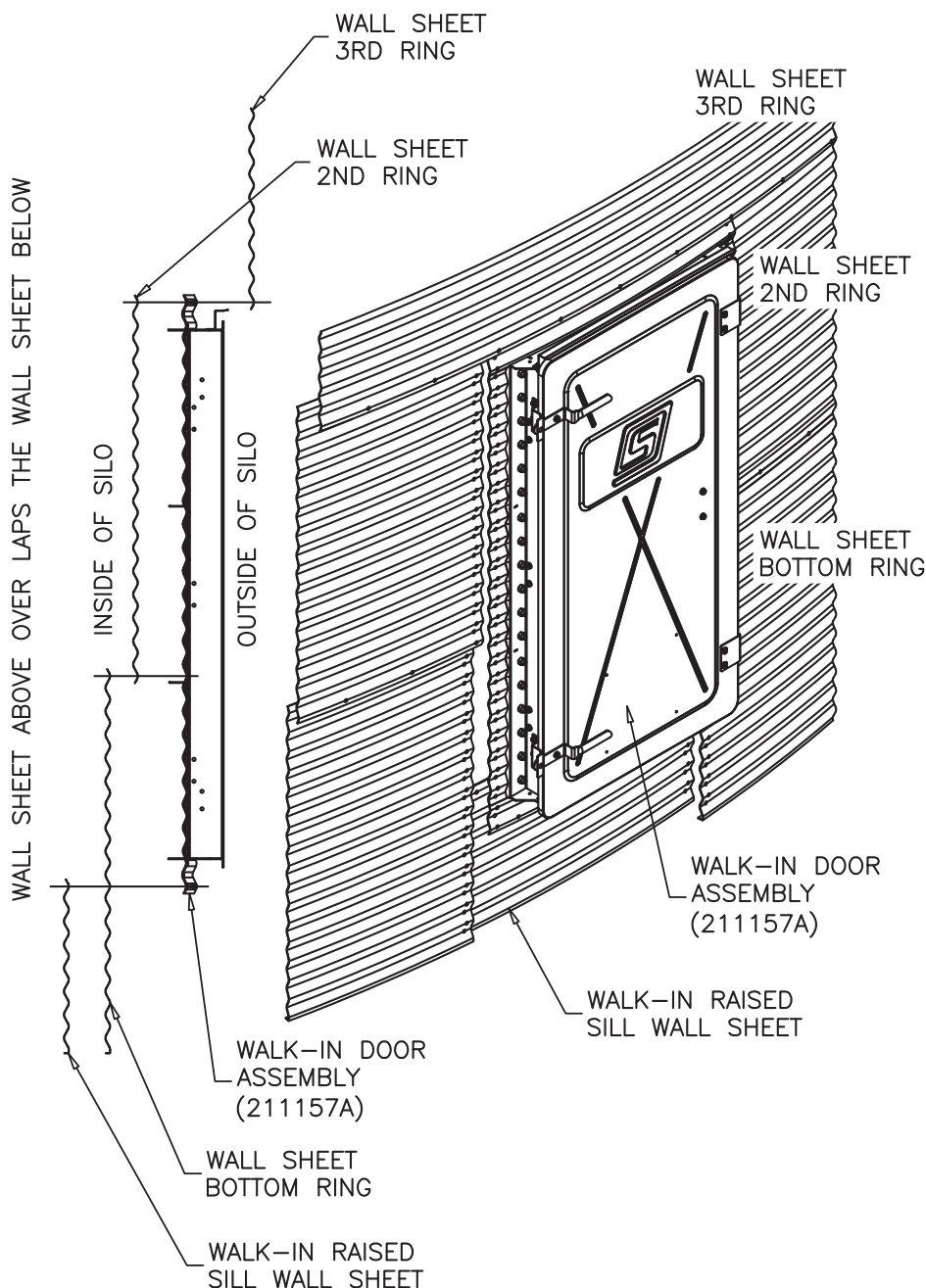

STEP 2

STANDARD POSITION FOR
WALK-IN RAISED DOOR

USE A DOUBLE ROW OF 3/16" [5]
BEAD SEALANT BETWEEN WALL
SHEETS & DOOR FRAME

BOLT DOOR INTO WALL SHEETS
AS SHOWN USING 3/8" X 1 1/2"
[10 X 38] HEX HEAD BOLTS W/SW
GRADE 8 AND 3/8" [10] HEX NUTS
FOR WALK-IN DOOR TO WALL
SHEET CONNECTIONS.

*INSERT (3) BOLTS AND NUTS
(FINGER TIGHTEN ONLY), AT
EACH CORNER OF DOOR FRAME
ASSEMBLY AND WALL SHEETS.

DO NOT DISTORT DOOR FRAME
ASSEMBLY WITH THE USE OF
ALIGNMENT OR DRIFT PUNCHES.
IF NECESSARY, DRILL OR REAM
HOLES ON DOOR JAMBS TO
INSERT BOLTS IN DOOR FRAME.

TIGHTEN FRAME BOLTS
STARTING AT THE CENTER OF
THE JAMBS AND WORKING
TOWARD TOP AND BOTTOM ON
EACH JAMB SIMULTANEOUSLY.
NEXT, BOLT HEADER & SILL
RINGS FROM CENTER OUT
TOWARDS CORNERS.

IF NECESSARY, LOOSEN CONE
HEAD BOLTS TO CENTER IN
DOOR PANEL SLOTS. **KEEP THE
INNER DOOR PANELS IN PLACE
TO MAKE THIS ADJUSTMENT.**
RETIGHTEN CONE HEAD
BOLTS.



**BEFORE BOLTING DOOR
INTO WALL SHEET OPENING,
CHECK THAT ALL INNER DOOR
PANELS ARE FLUSH AGAINST
JAMS AND LOCKED WITH
LATCH BARS.**



STEP 2

OPTIONAL POSITION FOR
WALK-IN DOOR

USE A DOUBLE ROW OF 3/16" [5]
BEAD SEALANT BETWEEN WALL
SHEETS & DOOR FRAME

BOLT DOOR INTO WALL SHEETS
AS SHOWN USING 3/8" X 1 1/2"
[10 X 38] HEX HEAD BOLTS W/SW
GRADE 8 AND 3/8" [10] HEX NUTS
FOR WALK-IN DOOR TO WALL
SHEET CONNECTIONS.

*INSERT (3) BOLTS AND NUTS
(FINGER TIGHTEN ONLY), AT
EACH CORNER OF DOOR FRAME
ASSEMBLY AND WALL SHEETS.

DO NOT DISTORT DOOR FRAME
ASSEMBLY WITH THE USE OF
ALIGNMENT OR DRIFT PUNCHES.
IF NECESSARY, DRILL OR REAM
HOLES ON DOOR JAMBS TO
INSERT BOLTS IN DOOR FRAME.

TIGHTEN FRAME BOLTS
STARTING AT THE CENTER OF
THE JAMBS AND WORKING
TOWARD TOP AND BOTTOM ON
EACH JAMB SIMULTANEOUSLY.
NEXT, BOLT HEADER & SILL
RINGS FROM CENTER OUT
TOWARDS CORNERS.

IF NECESSARY, LOOSEN CONE
HEAD BOLTS TO CENTER IN
DOOR PANEL SLOTS. **KEEP THE
INNER DOOR PANELS IN PLACE
TO MAKE THIS ADJUSTMENT.**
RETIGHTEN CONE HEAD
BOLTS.



**BEFORE BOLTING DOOR
INTO WALL SHEET OPENING,
CHECK THAT ALL INNER DOOR
PANELS ARE FLUSH AGAINST
JAMBS AND LOCKED WITH
LATCH BARS.**

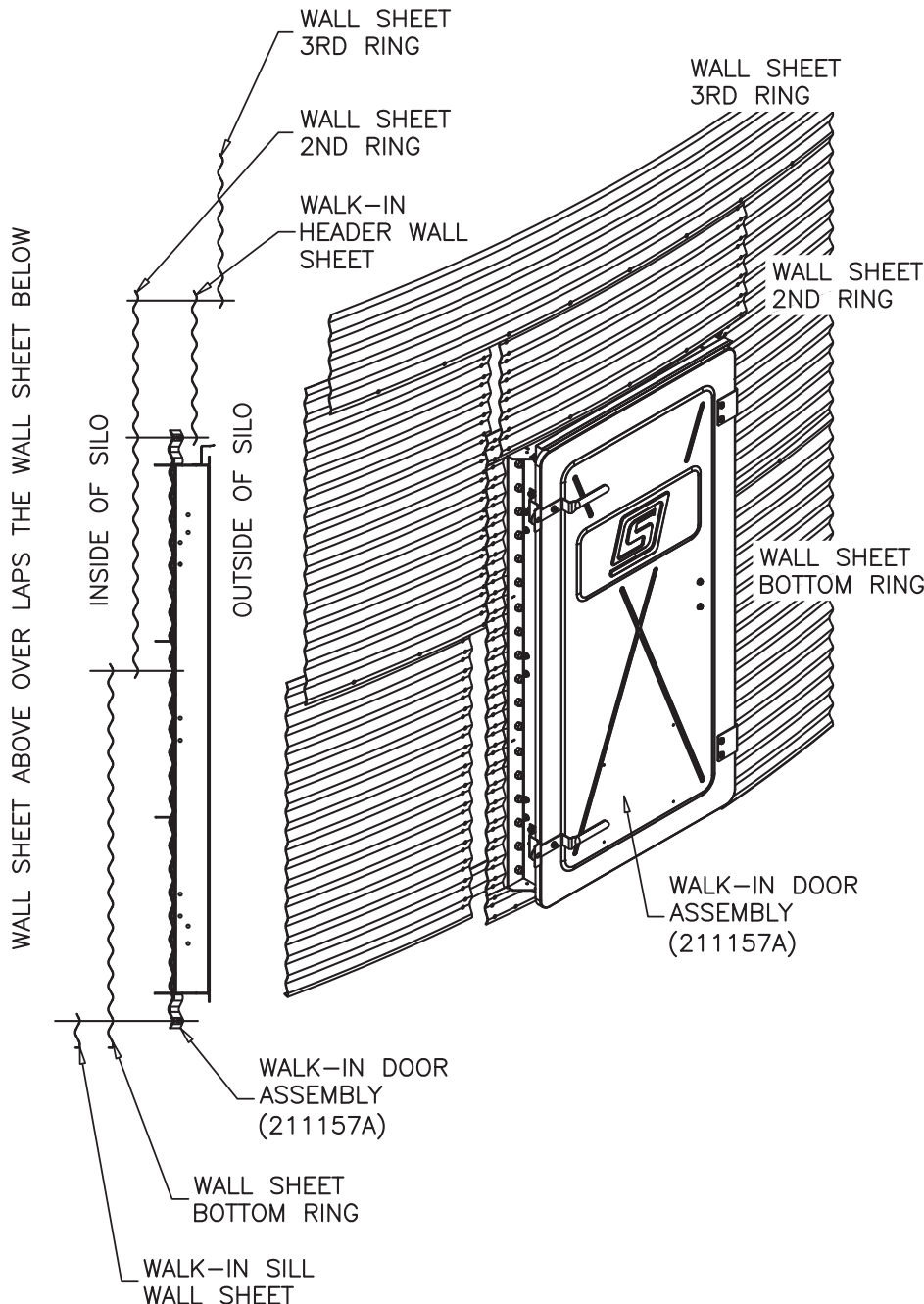

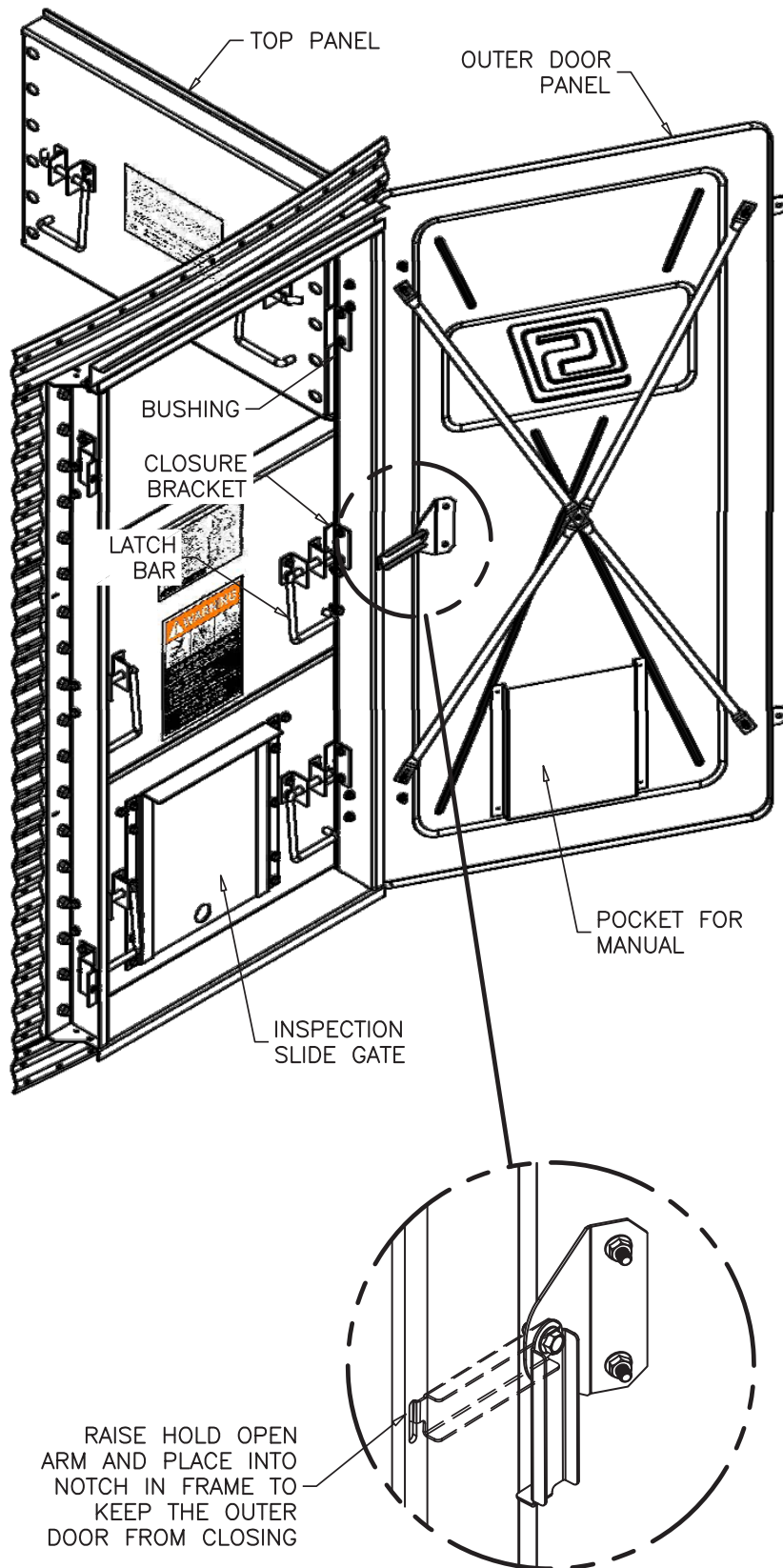

DOOR PANEL OPENING INSTRUCTIONS

OPEN DOOR PANELS BEGINNING WITH THE TOP PANEL

- LIFT LATCH BARS AND SLIDE THEM TOWARDS CENTER OF DOOR TO RELEASE THE PANEL FROM CLOSURE BRACKETS
- SIMULTANEOUSLY PULL THE LEFT LATCH BAR AND PUSH RIGHT SIDE OF DOOR PANEL INTO THE BIN TO CLEAR BUSHINGS ON THE RIGHT JAMB
- SWING THE DOOR PANEL INTO THE BIN TO OPEN POSITION.
- OPEN THE MIDDLE PANEL IN THE SAME FASHION AND THE BOTTOM PANEL LAST.

DOOR PANEL CLOSING INSTRUCTIONS

CLOSE DOOR PANELS BEGINNING WITH THE BOTTOM PANEL

- WHILE CLOSING THE PANEL, PULL THE LEFT LATCH BAR AND PUSH THE RIGHT SIDE OF THE PANEL TO CLEAR THE CONE HEAD BOLTS ON THE RIGHT JAMB
- SIMULTANEOUSLY PULL BOTH LATCH BARS UNTIL THE PANEL IS FLUSH WITH THE JAMBS
- TO LOCK, SLIDE THE LATCH BARS TOWARD THE JAMBS AND PUSH THE LATCH BARS DOWN ONTO THE CLOSURE BRACKET
- CLOSE THE MIDDLE PANEL IN THE SAME FASHION AND THE TOP PANEL LAST

CAUTION DOOR PANELS MUST CLEAR THE BUSHINGS ON THE RIGHT JAMB WHEN OPENING OR CLOSING THE PANELS.



WARNING ALL DOOR PANELS MUST BE CLOSED AND LOCKED WITH LATCH BARS BEFORE FILLING BIN



FIELD INSTALLATION OF OPTIONAL AUGER HOOD

MODIFY LOWER DOOR PANEL
WITH ITEMS SHOWN

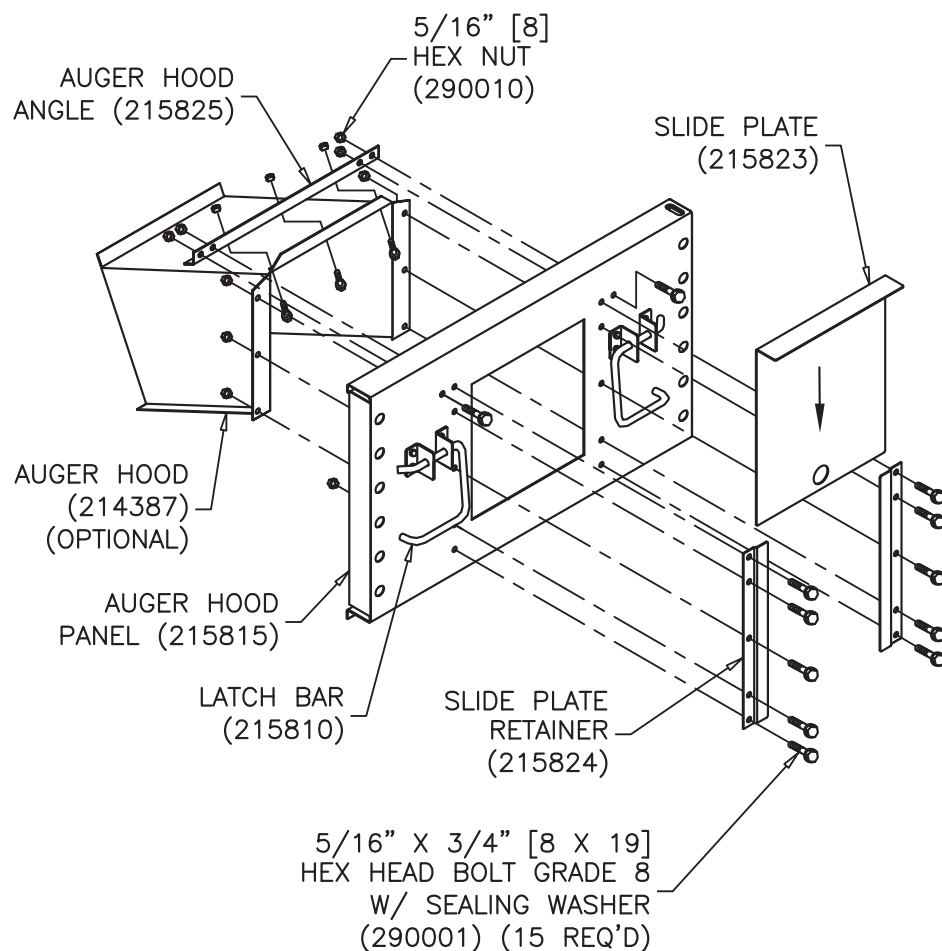

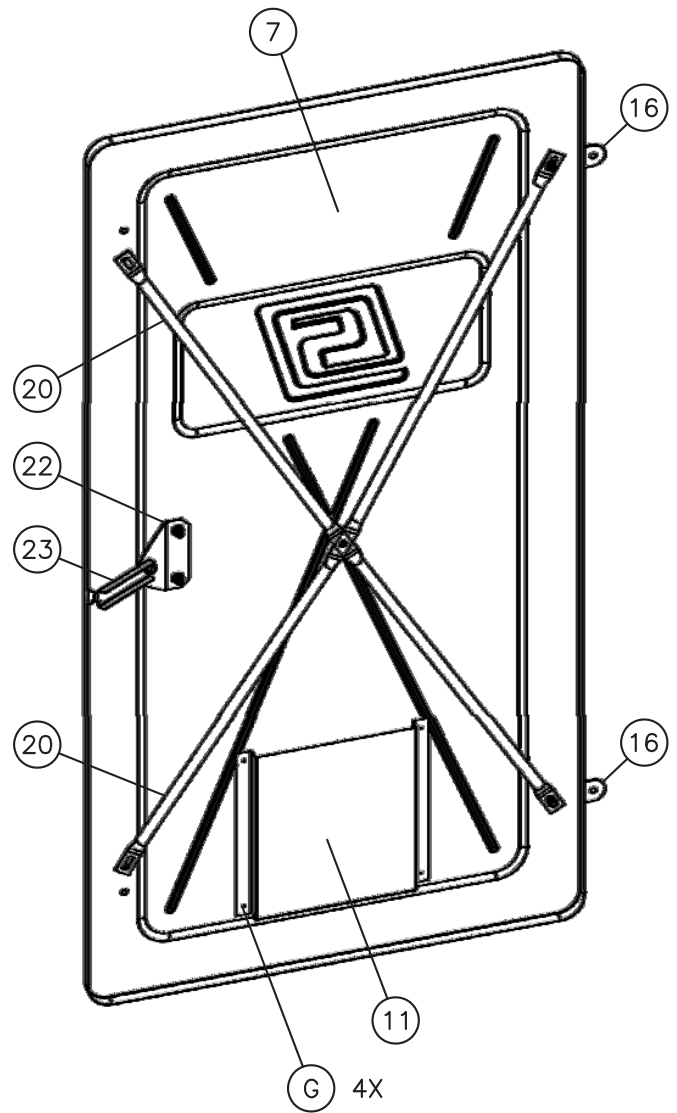
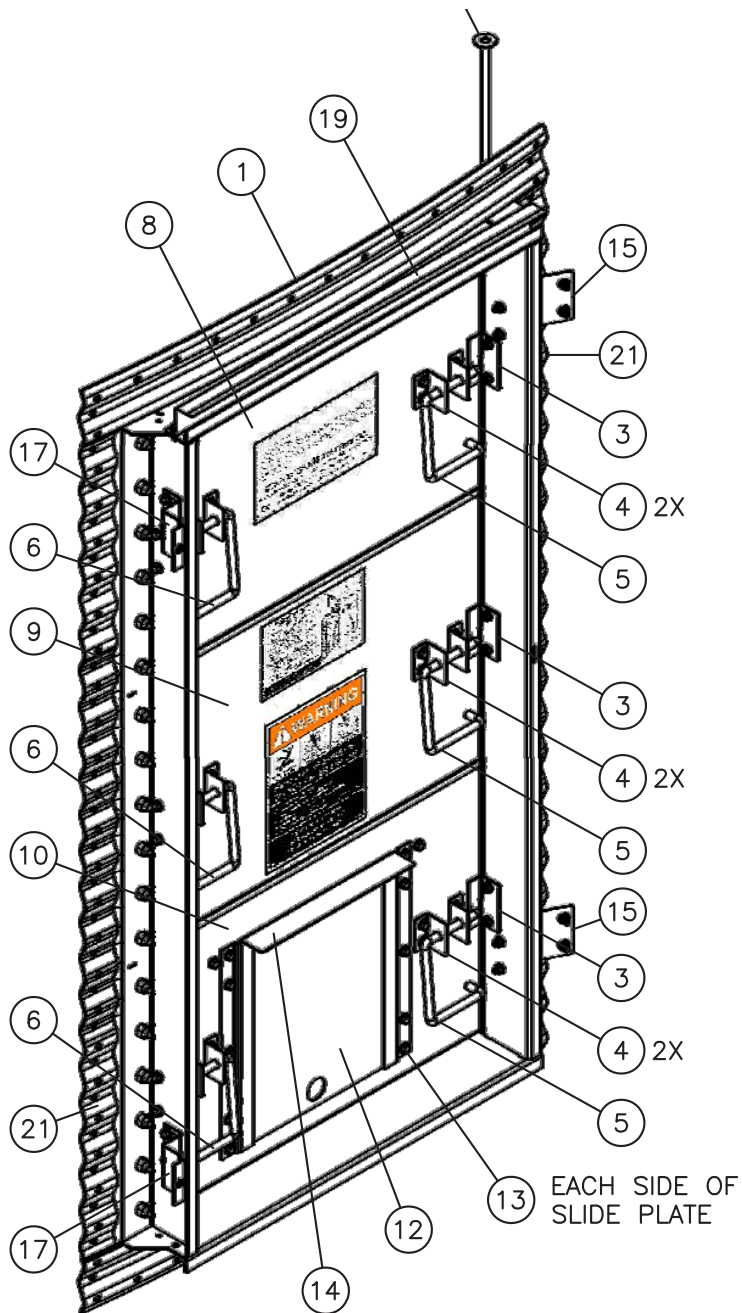



ITEM #	PART #	QTY	DESCRIPTION	WT EA (lbs)	WT TOTAL (kg)
1	210925	1	WALK IN DOOR FRAME ASSEMBLY (WELDED)	88.1#	40.0kg
2	210434	1	WALK IN DOOR 1/2" [13] DIA. HINGE ROD ASSEMBLY	3.400#	1.542kg
3	215807	6	LATCH BAR CLOSURE BRACKET	1.740#	0.789kg
4	215808	12	LATCH BAR HINGE BRACKET	2.280#	1.034kg
5	215809	3	RIGHT HAND LATCH BAR	2.760#	1.252kg
6	215810	3	LEFT HAND LATCH BAR	2.760#	1.252kg
7	215811	1	WALK IN DOOR OUTER DOOR PANEL	27.1#	12.3kg
8	2142695	1	WALK IN DOOR TOP FLAP	32.4#	14.7kg
9	2142696	1	WALK IN DOOR PLAIN FLAP	32.4#	14.7kg
10	2142697	1	WALK IN DOOR AUGER FLAP	27.4#	12.4kg
11	215820	1	WALK IN DOOR MANUAL SLEEVE	1.37#	0.62kg
12	215823	1	AUGER FLAP SLIDE PLATE	6.61#	3.00kg
13	215824	2	SLIDE PLATE RETAINER	1.94#	0.88kg
14	215825	1	AUGER HOOD RETAINING ANGLE	0.95#	0.43kg
15	210432	2	OUTER DOOR PANEL HINGE	2.418#	1.097kg
16	214073	2	WALK IN DOOR HANDLE	1.300#	0.590kg
17	214075	2	WALK IN DOOR LATCH LUG	1.020#	0.463kg
18	215500	2	WALK IN DOOR HANDLE SPACER	0.026#	0.012kg
19	215826	1	WALK IN DOOR SPLASH GUARD	1.74#	0.79kg
20	215827	2	WALK IN DOOR OUTER PANEL CROSS BRACE	2.22#	1.01kg
21	2142694	2	WALK IN DOOR CORRUGATED JAMB WITH FLAT FLANGE	24.4#	11.1kg
22	2142768	1	HOLD OPEN BRACKET	0.380#	0.2kg
23	2142769	1	HOLD OPEN ARM	0.220#	0.1kg
A	291661	36	1/2" X 1" [13 X 25] CONE HEAD BOLT GR. 8	3.528#	1.600kg
B	290104A	36	1/2" [13] SEALING WASHER W/ METAL BACKING (REVERSE USAGE)	0.385#	0.175kg
C	290018	36	1/2" [13] HEX NUT	1.296#	0.588kg
D	290001	75	3/8 " X 3/4" [8 X 19] HEX HEAD BOLT W/SW GR. 8	2.250#	1.021kg
E	290010	75	3/8 " [8] SERRATED FLANGE HEX NUT	1.350#	0.612kg
F	290095	14	3/8 " [8] FLAT WASHER	0.168#	0.076kg
G	290979	4	5/32" DIA. X 0.355" [4 X 9] CLOSED END ALUMINUM RIVET	0.016#	0.007kg
H	290023	1	CENTER LOAD & UNLOAD DECAL	0.100#	0.045kg
J	290037	1	OPEN/CLOSE INSTRUCTION DECAL	0.100#	0.045kg
K	290052	1	OSHA OUTER DOOR STICKER	0.100#	0.045kg
L	290902	1	SCAFCO LOGO DECAL	0.100#	0.045kg
M	290916	1	SCAFCO ADDRESS STICKER	0.100#	0.045kg
N	290922	1	1/2" [13] DIA. SELF-TIGHTENING SPRING HOSE CLAMP	0.006#	0.003kg
TOTAL WT:				274#	124kg



5400 E. Broadway Avenue
PO Box 11215
Spokane, WA 99211 USA

Phone: +1-509-535-1571
E-mail: info@SCAFCOgrain.com
www.SCAFCOgrain.com

GS3006E0120